

**PROJECT TEAM:**  
**ARCHITECT:**  
 BUELL KRATZER POWELL, P.C.  
 1525 LOCUST STREET  
 PHILADELPHIA, PA 19102  
 T: 215.557.6509  
**CIVIL ENGINEER:**  
 CARROLL ENGINEERING, INC  
 215 SCHILLING CIRCLE, STE 102  
 HUNT VALLEY, MD 21031  
 T: 410.785.7423  
**LANDSCAPE ARCHITECT:**  
 ROBINSON ANDERSON SUMMERS  
 28 WEST STATE STREET  
 MEDIA, PA 19063  
 T: 302.888.1544  
**STRUCTURAL ENGINEER:**  
 STRUCTURAL DESIGN STUDIO, INC  
 2225 EAST MURRAY HOLLADAY RD  
 SALT LAKE CITY, UT 84117  
 T: 801.274.3950  
**MEP ENGINEER:**  
 KOVACS, WHITNEY & ASSOCIATES  
 190 WEST OSTEND ST, STE 300  
 BALTIMORE, MD 21230  
 T: 410.244.7191

**CLIENT:**  
**MARYLAND ZOO**  
 THE MARYLAND ZOO IN BALTIMORE  
 1 SAFARI PLACE  
 BALTIMORE, MD 21217

**RED PANDA**  
 THE MARYLAND ZOO  
 IN BALTIMORE  
 1 SAFARI PLACE  
 BALTIMORE, MD 21217

THIS DRAWING IS TO ILLUSTRATE THE WORK TO BE DONE. THE ARCHITECT IS NOT RESPONSIBLE FOR THE MEANS, METHODS, TECHNIQUES, SEQUENCES AND PROCEDURES USED TO DO THE WORK OR THE SAFETY ASPECTS OF CONSTRUCTION, AND NOTHING ON THE DRAWING EXPRESSED OR IMPLIED CHANGES THIS CONDITION. CONTRACTOR SHALL BE RESPONSIBLE FOR DETERMINING HOW THEY AFFECT THE WORK. SUBMITTAL OF A BID TO PERFORM THIS WORK IS AN ACKNOWLEDGMENT OF THESE RESPONSIBILITIES, AND THAT THEY HAVE BEEN FULLY CONSIDERED IN PLANNING OF THE WORK AND THE BID PRICE. NO CLAIMS FOR EXTRA CHARGES DUE TO THESE CONDITIONS WILL BE FORTHCOMING.

**SEAL:**

PROFESSIONAL CERTIFICATION: HEREBY CERTIFY THAT THESE DOCUMENTS WERE PREPARED OR APPROVED BY ME, AND THAT I AM A DAILY LICENSED PROFESSIONAL ENGINEER UNDER THE LAWS OF THE STATE OF MARYLAND, LICENSE NO. 14446, EXPIRATION DATE 9/25/25.

DATE:	JANUARY 14, 2025
PROJECT NO:	2023-10.04
DRAWN BY:	MJE
CHECKED BY:	CMS
SUBMISSION:	DATE
BID SET:	01/14/2025
REVISION:	DATE
ADDENDUM 1:	02/03/2025

**DRAWING TITLE:**  
 EXISTING  
 CONDITIONS  
 PLAN

**DRAWING NO:**  
 C100

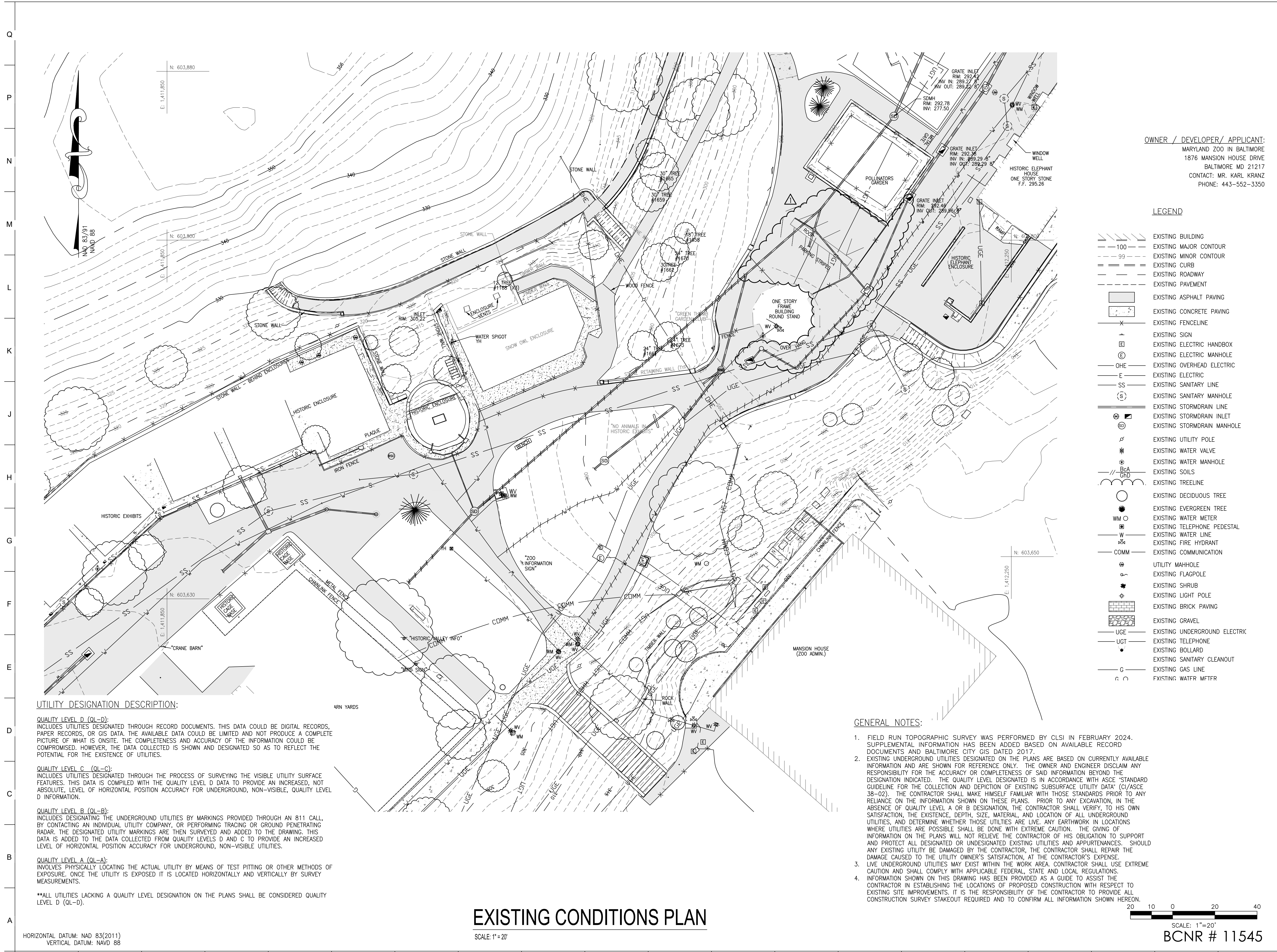

**UTILITY DESIGNATION DESCRIPTION:**

**QUALITY LEVEL D (QL-D):**  
 INCLUDES UTILITIES DESIGNATED THROUGH RECORD DOCUMENTS. THIS DATA COULD BE DIGITAL RECORDS, PAPER RECORDS, OR GIS DATA. THE AVAILABLE DATA COULD BE LIMITED AND NOT PRODUCE A COMPLETE PICTURE OF WHAT IS ONSITE. THE COMPLETENESS AND ACCURACY OF THE INFORMATION COULD BE COMPROMISED. HOWEVER, THE DATA COLLECTED IS SHOWN AND DESIGNATED SO AS TO REFLECT THE POTENTIAL FOR THE EXISTENCE OF UTILITIES.

**QUALITY LEVEL C (QL-C):**  
 INCLUDES UTILITIES DESIGNATED THROUGH THE PROCESS OF SURVEYING THE VISIBLE UTILITY SURFACE FEATURES. THIS DATA IS COMPILED WITH THE QUALITY LEVEL D DATA TO PROVIDE AN INCREASED, NOT ABSOLUTE, LEVEL OF HORIZONTAL POSITION ACCURACY FOR UNDERGROUND, NON-VISIBLE, QUALITY LEVEL D INFORMATION.

**QUALITY LEVEL B (QL-B):**  
 INCLUDES DESIGNATING THE UNDERGROUND UTILITIES BY MARKINGS PROVIDED THROUGH AN 811 CALL, BY CONTACTING AN INDIVIDUAL UTILITY COMPANY, OR PERFORMING TRACING OR GROUND PENETRATING RADAR. THE DESIGNATED UTILITY MARKINGS ARE THEN SURVEYED AND ADDED TO THE DRAWING. THIS DATA IS ADDED TO THE DATA COLLECTED FROM QUALITY LEVELS D AND C TO PROVIDE AN INCREASED LEVEL OF HORIZONTAL POSITION ACCURACY FOR UNDERGROUND, NON-VISIBLE UTILITIES.

**QUALITY LEVEL A (QL-A):**  
 INVOLVES PHYSICALLY LOCATING THE ACTUAL UTILITY BY MEANS OF TEST PITTING OR OTHER METHODS OF EXPOSURE. ONCE THE UTILITY IS EXPOSED IT IS LOCATED HORIZONTALLY AND VERTICALLY BY SURVEY MEASUREMENTS.

**\*\*ALL UTILITIES LACKING A QUALITY LEVEL DESIGNATION ON THE PLANS SHALL BE CONSIDERED QUALITY LEVEL D (QL-D).**

**GENERAL NOTES:**

- FIELD RUN TOPOGRAPHIC SURVEY WAS PERFORMED BY CLSI IN FEBRUARY 2024. SUPPLEMENTAL INFORMATION HAS BEEN ADDED BASED ON AVAILABLE RECORD DOCUMENTS AND BALTIMORE CITY GIS DATED 2017.
- EXISTING UNDERGROUND UTILITIES DESIGNATED ON THE PLANS ARE BASED ON CURRENTLY AVAILABLE INFORMATION AND ARE SHOWN FOR REFERENCE ONLY. THE OWNER AND ENGINEER DISCLAIM ANY RESPONSIBILITY FOR THE ACCURACY OR COMPLETENESS OF SAID INFORMATION BEYOND THE DESIGNATION INDICATED. THE QUALITY LEVEL DESIGNATED IS IN ACCORDANCE WITH ASCE "STANDARD GUIDELINE FOR THE COLLECTION AND DEPICTION OF EXISTING SUBSURFACE UTILITY DATA" (31/ASCE 38-02). THE CONTRACTOR SHALL MAKE HIMSELF FAMILIAR WITH THOSE STANDARDS PRIOR TO ANY RELIANCE ON THE INFORMATION SHOWN ON THESE PLANS. PRIOR TO ANY EXCAVATION, IN THE ABSENCE OF QUALITY LEVEL A OR B DESIGNATION, THE CONTRACTOR SHALL VERIFY, TO HIS OWN SATISFACTION, THE EXISTENCE, DEPTH, SIZE, MATERIAL, AND LOCATION OF ALL UNDERGROUND UTILITIES, AND DETERMINE WHETHER THOSE UTILITIES ARE LIVE. ANY EARTHWORK IN LOCATIONS WHERE UTILITIES ARE POSSIBLE SHALL BE DONE WITH EXTREME CAUTION. THE GIVING OF INFORMATION ON THE PLANS WILL NOT RELIEVE THE CONTRACTOR OF HIS OBLIGATION TO SUPPORT AND PROTECT ALL DESIGNATED OR UNDESIGNATED EXISTING UTILITIES AND APPURTENANCES. SHOULD ANY EXISTING UTILITY BE DAMAGED BY THE CONTRACTOR, THE CONTRACTOR SHALL REPAIR THE DAMAGE CAUSED TO THE UTILITY OWNER'S SATISFACTION, AT THE CONTRACTOR'S EXPENSE.
- LIVE UNDERGROUND UTILITIES MAY EXIST WITHIN THE WORK AREA. CONTRACTOR SHALL USE EXTREME CAUTION AND SHALL COMPLY WITH APPLICABLE FEDERAL, STATE AND LOCAL REGULATIONS.
- INFORMATION SHOWN ON THIS DRAWING HAS BEEN PROVIDED AS A GUIDE TO ASSIST THE CONTRACTOR IN ESTABLISHING THE LOCATIONS OF PROPOSED CONSTRUCTION WITH RESPECT TO EXISTING SITE IMPROVEMENTS. IT IS THE RESPONSIBILITY OF THE CONTRACTOR TO PROVIDE ALL CONSTRUCTION SURVEY STAKEOUT REQUIRED AND TO CONFIRM ALL INFORMATION SHOWN HEREON.

**EXISTING CONDITIONS PLAN**  
 SCALE: 1"=20'

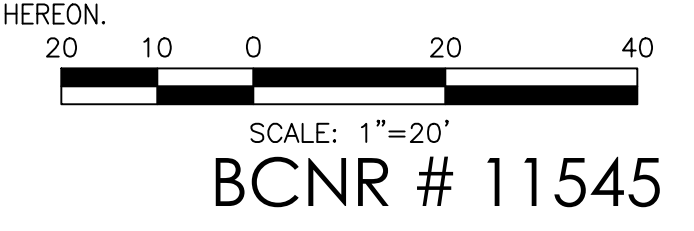

HORIZONTAL DATUM: NAD 83(2011)  
 VERTICAL DATUM: NAVD 88

Q  
P  
N  
M  
L  
K  
J  
H  
G  
F  
E  
D  
C  
B  
A

1 2 3 4 5 6 7 8 9 10 11 12 13 14 15 16 17 18 19 20